



Revitalization of Historic Conservation Areas: The Landscape Design for Yongqing Fang Phase III in Guangzhou, China

Hu SUN

Guangzhou S.P.I Design Co., Ltd.

© Guangzhou S.P.I Design Co., Ltd.
1

1. Aerial night view of Yongqing Fang Phase III.

FEATURES

Historic Conservation Area; Urban Public Space; Urban Design; Urban Renewal; Cultural Landscape; Landscape Design

EDITED BY Tina TIAN

1 Introduction

The regeneration and revitalization of historic conservation areas is not only of significant importance for the transformation of urban spaces but also has become a widely discussed topic in recent urban renewal efforts. The Yongqing Fang, sitting in the Enning Road

Historic Conservation Area in Guangzhou, China is renowned as “the most beautiful old-style street in Guangzhou.” Through its staged redevelopment since 2016, Yongqing Fang has turned into an attractive destination with distinctive Lingnan (Cantonese) characteristics, providing places for specialty dining, creative industries, cultural performances, recreational and cultural experiences, etc. This renewal project has also stimulated the coordinated development of the surrounding areas.

2 Design Challenges and Goals

The Yongqing Fang project consists of three phases with varied priorities. The site of Phase III, the focus of this article, covers an area of 2,645 m² and is adjacent to two newly built commercial complexes, which requires the public spaces to accommodate more large-scale commercial activities, cultural events, and recreational

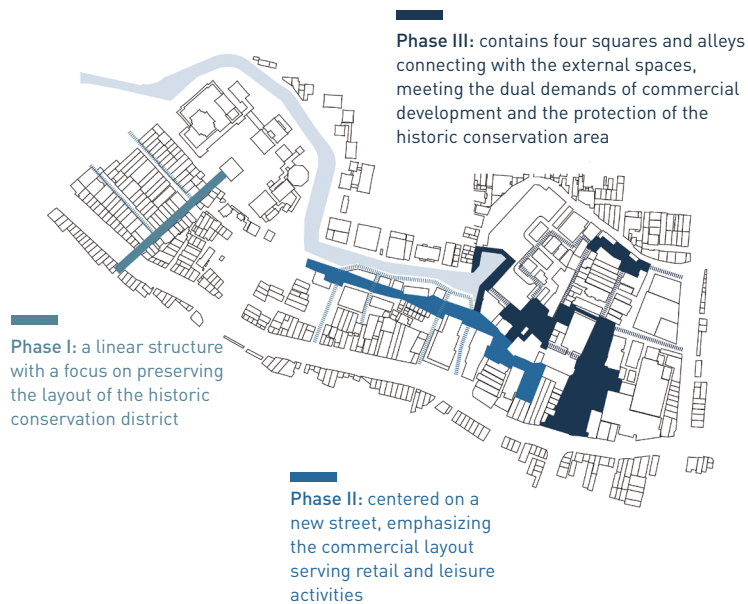

2 © Guangzhou S.P.I Design Co., Ltd.

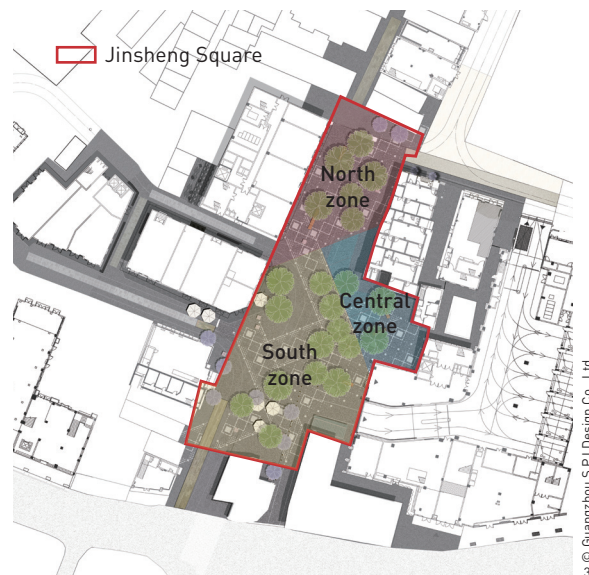

3 © Guangzhou S.P.I Design Co., Ltd.

2. Development priority of each phase of the Yongqing Fang project.
3. Master plan of the Yongqing Fang Phase III.
4. Aerial night view of the Jinsheng Square.
5. Climbing plants such as *Hedera nepalensis* var. *sinensis*, *Ficus pumila*, and *Cissus sicyoides* were selected for the building facades, highlighting the Cantonese atmosphere of the project.
6. The Jinsheng Square provides a pleasant social space for local residents.

programs. Therefore, the landscape design needs to address the integration of the site with multiple streets, alleys, and commercial spaces to create a complete pedestrian circulation, in addition to providing spaces for residents' diverse daily recreational activities.

3 Design Principles

The primary objective of the landscape design is the preservation and celebration of the historical and cultural contexts of the area. By defining protection goals and extracting preserved elements, micro-

renovation measures were employed to maintain the area's fabrics and while rejuvenating its portrait. Additionally, the design needs to optimize spatial flows to improve pedestrian dynamics and enhance connectivity and permeability thus maximizing the site's openness and vitality.

3.1 Spatial Zoning

The core of the landscape design for Phase III is the Jinsheng Square, which is divided into the south, central, and north zones. The south zone covers the main entrance to the square and is

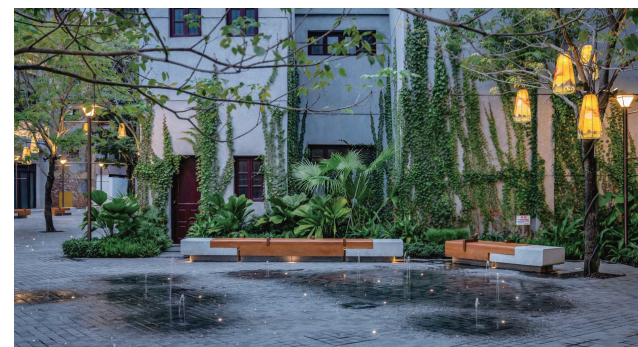

closer to the commercial complexes, so its design emphasizes the connection with commercial and external spaces. The central zone is envisioned as a relatively independent area, where diverse experiences can be provided through the combination with dry fountains. The secondary entrance to the square is located in the north zone, where the design highlights rich planting and seating arrangements to create a relatively quiet resting area.

3.2 Spatial Flow Reorganization

The design reconstructs the pedestrian flows connecting the Jinsheng Square to the surrounding streets and alleys, and enhances spatial quality and user experience by collecting feedback from local residents and users of the public spaces from the previous two phases. Meanwhile, careful consideration was given to the spatial usage scenarios and functions of each street and alley, creating linear spaces that reflect distinctive historical and cultural themes.

3.3 Enhancement of the Connectivity and Permeability of Architectural Interfaces

In the design of the main architectural interfaces, efforts are made to maximize spatial connectivity and permeability, primarily through variations in paving patterns and behavioral activity guidance. For the south and north zones, spatial units and visual



© Guangzhou S.P.I Design Co., Ltd. 7

7. The use of different materials and lighting design echoes and reinforces the Cantonese characteristics of the alleys.
8. Design evolution of paving patterns.
9. The Jinsheng Square forms flexible spaces for different usage scenarios.

lines are defined by changes in paving patterns—the size of spatial units ranges from 10 ~ 15 m for the south zone while 8 ~ 12 m for the north zone. Meanwhile, for the central zone, areas for active and passive recreational activities are defined with dry fountains.

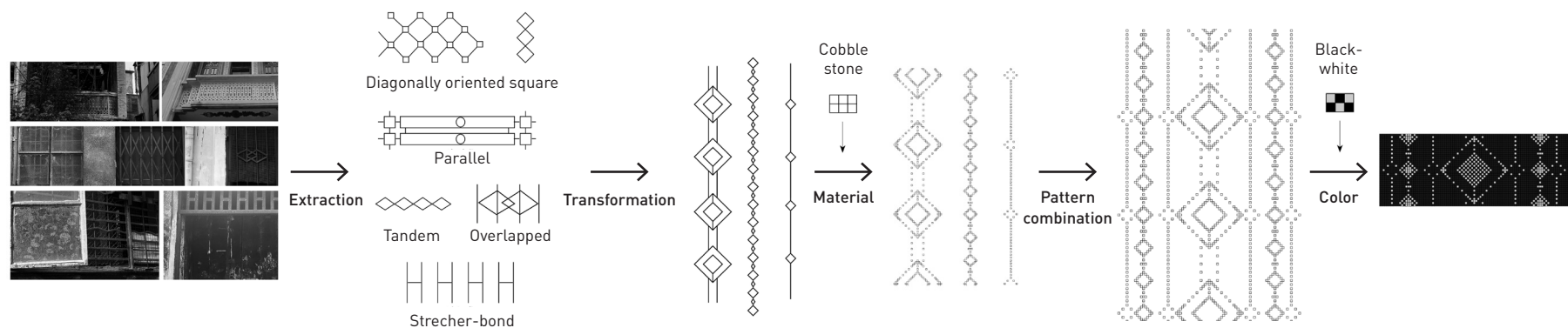

© Guangzhou S.P.I Design Co., Ltd. 8

Daily (fountain on)

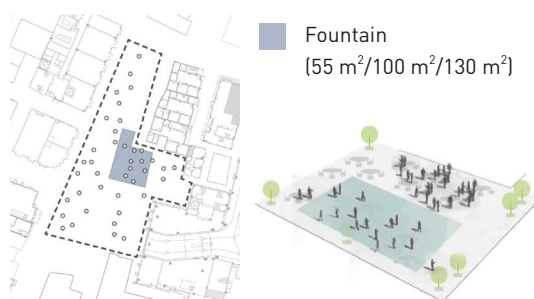

Street market

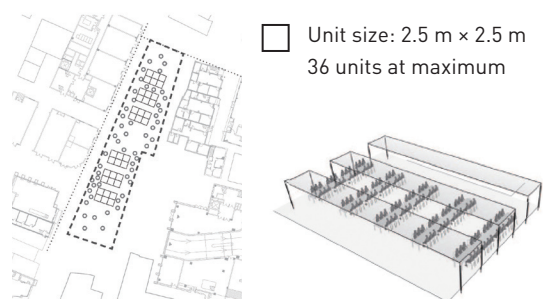

Events

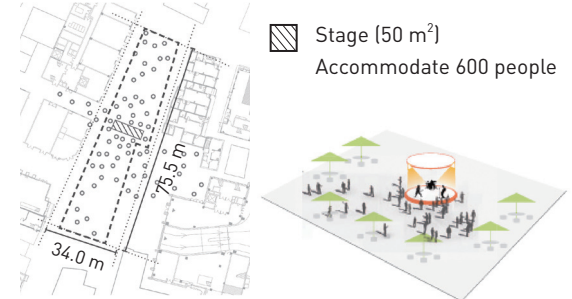

© Guangzhou S.P.I Design Co., Ltd. 9



© Guangzhou S.P.I Design Co., Ltd. 10

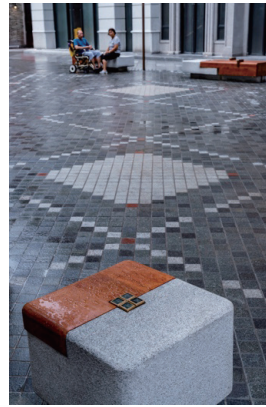

© Guangzhou S.P.I Design Co., Ltd. 11



© Guangzhou S.P.I Design Co., Ltd. 12

10. Stone sculpture with a concave relief.
11. The benches use a patchwork of different materials, echoing the overall design style.
12. The detail of the “folded paper birds” reinforces the identity of the historic neighborhood.

3.4 Extraction of Traditional Cultural Elements

The design incorporates traditional cultural elements from the Cantonese regions into details such as benches, tree pits, flower boxes, and pavements. For example, designers extracted various quadrilateral elements from local Cantonese-style residences and evolved them into patterns for the paving design. Designers also created different forms of “folded paper birds” inspired by local cultural anecdotes, creating distinctive urban furniture.

4 Conclusions

The landscape design for Yongqing Fang Phase III is an exploration in the renewal and operation of a historic conservation area by integrating various functions to meet the diverse needs of local residents and tourists. This revitalized urban public space not only enhances residents’ life quality but also maximizes the commercial vitality of the Yongqing Fang by combining captivating

historic buildings with traditional and folk activities. The project has become a new urban landmark in Guangzhou and serves as a reference for the renewal and redevelopment of historic conservation areas in China.

Competing interests | The author declares that he has no competing interests.

Project Name: Landscape Design for Yongqing Fang Phase III

Location: Guangzhou, Guangdong Province, China

Area (size): 2,645 m²

Client: Guangzhou WanEn Property Investment Co., Ltd.

Landscape Architecture: Guangzhou S.P.I Design Co., Ltd.

Principal: Hu Sun

Design Team: Songmin Liu, Xiaosan Liang, Biwei Zhang, Xiaodong Liang, Xiuwen Xiong, Haobo Xu, Long Kuang

Design Time: June 2022

Completion Time: September 2023

<https://doi.org/10.15302/J-LAF-0-040006>

收稿日期 | 2024-06-15 录用日期 | 2024-08-30

中图分类号 | TU986 文献标识码 | B

城市历史文化街区更新——以广州市永庆坊三期景观设计为例

孙虎

广州山水比德设计股份有限公司

项目关键词

历史文化街区；城市公共空间；城市设计；
城市更新；文化景观；景观设计

编辑 田乐

项目地点：中国广东省广州市

项目面积：2 645m²

项目委托：广州万恩产业投资有限公司

景观设计：广州山水比德设计股份有限公司

首席设计师：孙虎

设计团队：刘宋敏、梁小叁、张碧玮、梁晓栋、
熊秀文、徐浩博、邝龙

设计时间：2022年6月

建成时间：2023年9月