



项目地址：河北省固安市
项目面积：29 000m²
项目委托：华夏幸福集团
建筑设计：维思平建筑设计
首席设计师：吴钢
项目团队：王丽娜、李玉洁
设计时间：2011年7月
施工时间：2011年10月
建成时间：2012年5月

Location: Gu'an, Hebei Province
Area (size): 29,000 m²
Client: China Fortune Land Development Co., Ltd.
Architecture Design: WSP ARCHITECTS
Chief Designer: Gang Wu
Project Team: Lina Wang, Yujie Li
Design Period: July, 2011
Construction Period: October, 2011
Completion Time: May, 2012

1. 建筑两侧的灯箱草坡，栽植园景树，在突显建筑体量的同时形成优美的背景。
1. The turfed slope with lamp pools, with specimen tree planting, on both sides of the building, giving scale to the architectural design.

收稿时间 / Received Date | 中图分类号 / TU986.2
2014-04-17 | 文献标识码 / B

河北省固安规划展览馆景观设计

Landscape Design of the Gu'an Planning Exhibition Hall, Hebei

维思平建筑 / WSP ARCHITECTS

整理 Edited by /
田乐 Tina TIAN
翻译 Translated by /
刘琴博 Qinbo LIU

摘要 ……

固安规划展览馆的建筑设计反映了固安的历史文化和城市肌理。固安素有“柳编之乡”的美誉，因此建筑材料通过模拟编织的纹理，寓意“编织未来城市之光”。景观设计充分尊重建筑师简约线条的设计理念及方法，通过铺装设计使建筑与周围环境“编织”在一起，体现出固安独特的历史文化特色。

关键词 ……

城市客厅；公共景观；文化；院落

Abstract ……

The design of Gu'an's new Planning Exhibition Hall showcases the region's historic culture and urban texture. As Gu'an is known as the town of wickerwork, the architecture imitates the traditional weaving texture, while the landscape continues the architectural lines. The paving design knits the architecture and environment together, highlighting the uniqueness of Gu'an's historical culture.

Key words ……

City Living Room; Public Landscape; Culture; Courtyard

1 场地背景

固安地处北京中轴线南端，天安门正南50km处的黄金位置，与大兴区隔永定河相望。本项目位于固安总体规划城市核心区的中心地带，北邻锦绣大道，西邻106国道，南邻创新路，交通便利。

2 设计指导原则

(1) 创造一种充满智慧的设计方案，为市民带来富有精神内涵与艺术魅力的空间体验；

(2) 通过生态手段调节周边居住区的气候环境，减少城市热岛效应；

(3) 运用现代设计手法，实现场地历史与未来的传承。

3 设计理念

固安素有“柳编之乡”的美誉，建筑设计通过模拟编织的纹理来体现固安独特的历史文化特色。景观设计尊重并延续了建筑中简约构架线条的设计理念及方法，通过铺装设计使建筑与周围环境“编织”在一起。

我们希望为周边的居民设计一个可人人共享、集聚人气的，可承担休闲、展览、教育等多种功能的城市客厅，为人们

的生活带来真正意义上的改善。因此，方案设计需要兼顾在大尺度上营造城市形象与在小尺度上创建宜人景观，从而实现项目的美好愿景。

4 种植设计

植物材料以乡土树种为主，在形成高低错落的层次感的同时，结合植被的色彩、气味，以及当地盛行风向来进行设计，使不同空间中的景观能够随着季节的改变而交替变换，避免了景致的单调。与此同时，通过水景及种植设计降低了噪音、沙尘、尾气对人的影响，减少了热岛



- | | | | |
|-------------------------|--------------------------|-------------------------------------|-----------------------------|
| 1 入口水广场 Water Square | 5 紫藤花廊 Wisteria Pavilion | 9 莲花池苑 Lotus Courtyard | 13 柿树林 Persimmon Grove |
| 2 斜坡草坪 Turfed Slope | 6 生态停车场 Eco-parking | 10 雨水喷泉广场 Rainwater Fountain Square | 14 法桐林 Oriental Plane Grove |
| 3 银杏树阵 Ginkgo Grove | 7 中庭水苑 Atrium Water Pool | 11 儿童乐园 Children Playground | 15 花灌木 Flowering Shrubs |
| 4 樱花院落 Cherry Courtyard | 8 竹园 Bamboo Garden | 12 杨树林 Poplar Grove | 16 下沉庭院 Sunken Courtyard |

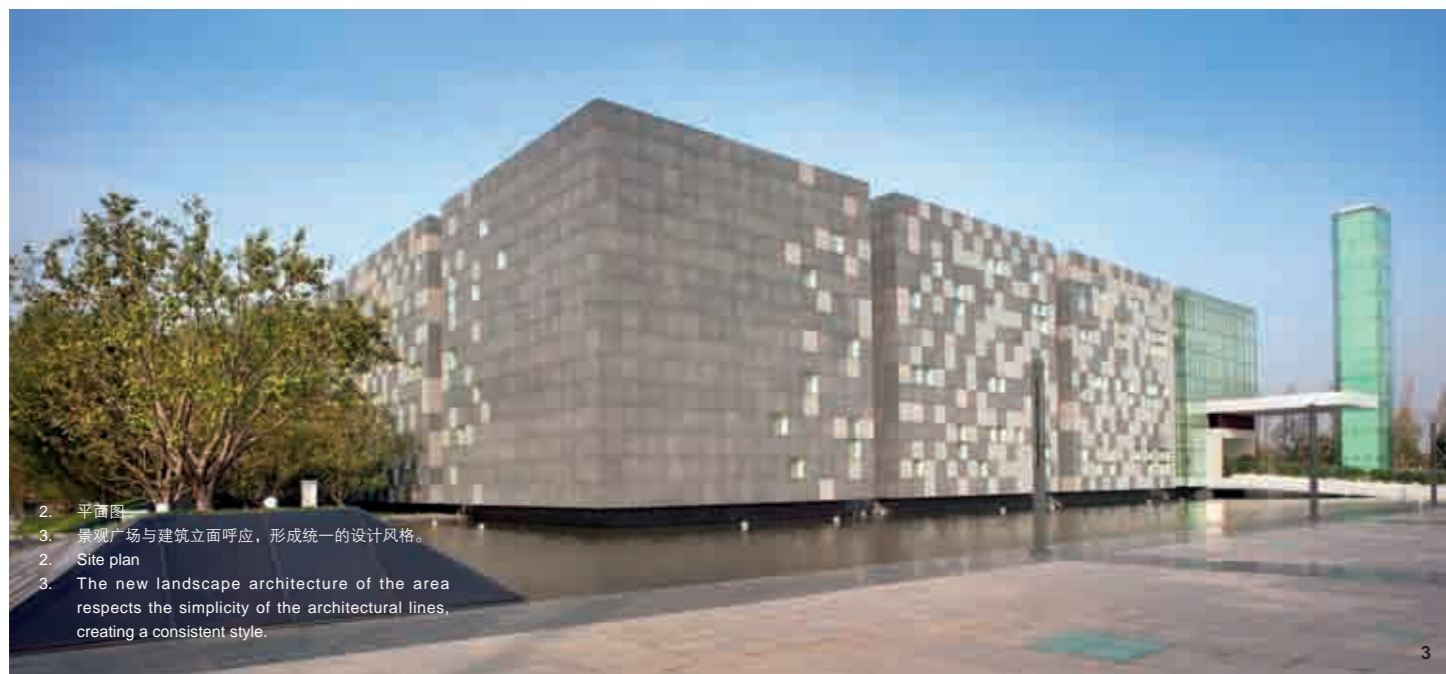

2. 平面图
3. 景观广场与建筑立面呼应，形成统一的设计风格。
2. Site plan
3. The new landscape architecture of the area respects the simplicity of the architectural lines, creating a consistent style.

效应，为周边居住区创造出了一种生态、舒适的生活环境。

5 空间营造

项目通过道路网格来连接大小不同的各个景观空间：

(1) 入口水广场：广场结合了入口的引导及展示功能，静水面的设计赋予了整个广场强烈的仪式感。地面铺装及灯砖的设计与建筑立面相呼应，展现了整体统一的设计风格。水池两侧灯箱树池的设计结合树木种植，更加突出了建筑的体量感。

(2) 银杏林：在广场两侧分别种植银杏树阵，使得广场的空间界定更加明确。林中布设的汀步小径，可以使人们更好地深入林中。金黄的银杏落叶令汀步结合草坪的设计在秋冬季节尤为引人入胜，为游人带来了丰富的感官体验。

(3) 樱花院落：这是一个以景观墙围合、以樱花为主题的水景空间。每年三月，飘落的花雨散落在水面上，营造出“落英缤纷”的浪漫氛围。

(4) 紫藤花廊：以廊架围合成院落主体框架，栽种的紫藤形成半围合院落。每年四月，廊架上爬满紫藤花，在花下设置坐凳，可供游人惬意地享受芬芳和



美景。

(5) 莲花池苑：利用竹林围合出以睡莲为主题的庭院，营造出适宜冥想的宁静空间。LAF

4. 入口水广场：静水面的设计赋予了整个广场强烈的仪式感。
5. 斜坡草坪：地面铺装一直延续到斜坡草坪上。
4. Water Square: the design of still water brings a strong sense of rite to the entire space.
5. Turfed Slope: the pavement extends to the side of turfed slopes.





1 Site Context

Gu'an is located at the southernmost part of Beijing, 50 km south of Tian'anmen Square and across the Yongding River from Daxing District. The site is at the core of the Gu'an central city. Jinxiu Road borders it to

the north, State Road 106 to the west, and Chuangxin Road to the south.

2 Design Principles

(1) Creating an intelligent design that brings people to a place of spiritual intention

and reflection.

(2) Employing ecological approaches to adjust the design to meet the climatic needs of the surrounding environment and reduce the urban-heat-island effect.

(3) Considering the history heritages and



- 6, 7. 斜坡草坪的灯箱设计
- 8. 银杏树阵
- 9. 樱花院落
- 6, 7. The lamp pools of turfed slopes
- 8. Ginkgo Grove
- 9. Cherry Courtyard

the future needs of the site using modern design.

3 Concept

As Gu'an is known as the town of wickerwork, the architecture imitates this historic weaving texture. The new landscape architecture of the area respects this historic precedent and the simplicity of the architectural lines. Through a detailed paving pattern, the landscape knits the architecture and environment together.

We hope the new space will provide residents in the surrounding neighborhoods with an urban living room that supports various functions such as sharing spaces, gathering areas, and room for recreation, exhibition and education — activities that will improve people's lives in a real sense. During the design phase we needed to consider both the scale of the city and smallness of the landscape in order to make the project's goals a reality.

4 Planting Design

Native plants are favored as the chosen plant materials. When these plants are arranged at different levels, the plants' color, scent, and microclimate needs are

considered within the design. The planting design changes through the seasons, avoiding a tedious landscape. Meanwhile, the water and plant design reduces the effects of noise, dust, and exhaust pollution. Furthermore, it reduces the urban-heat-island effect, creating both a functional and comfortable ecological environment for the surrounding community.

5 Creating Spaces

The project uses road grids to connect the landscape:

(1) Water Square: This central square functions as a place of entrance and exhibition. The design of still water brings a strong sense of rite to the entire space. The pavement design and lighting-brick responds to the architectural facades and ties the design style together. The tree pools light on both sides of the water body, giving scale to the architectural design.

(2) Ginkgo Grove: The ginkgo grove, planted on both sides of the square, defines the space and gives a ceremonial and ritual sense to the square. A stepping-stone path brings visitors from the square into the woods. The golden yellow leaves of the fall ginkgo, combined with the path of the lawn, is very inviting and attractive in autumn.





10



11

(3) Cherry Courtyard: The water landscape is enclosed by walls and takes the plantings of cherry trees as its main feature. In March, the newly blossomed cherry flowers create a magical landscape of falling petals.

(4) Wisteria Pavilion: This courtyard is formed by plantings of wisteria. When the wisteria blooms in April, benches are placed in the courtyard for people to enjoy the beautiful and sweet smelling landscape.

(5) Lotus Courtyard: This final courtyard is filled with water lilies and enclosed by bamboo, presenting a quiet space good for mediation. **LAF**

10, 11. 莲花池苑：利用竹林围合出以睡莲为主题的庭院，营造出适宜冥想的宁静空间。

12. 铺装细部

10, 11. Lotus Courtyard: this final courtyard is filled with water lilies and enclosed by bamboo, presenting a quiet space good for mediation.

12. Details of the pavement



12